

Heating Hoses

Pressure Hoses

When choosing a pressure hose, please observe the minimum bending radius in order to avoid leakage.

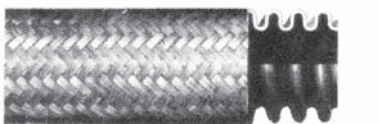
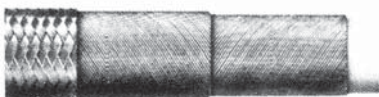
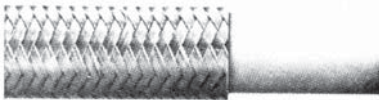

T1

Smooth PTFE hose with one braided layer of stainless steel wire (1.4301), max. operating temperature 250 °C

nominal diameter	4	6	8	10	12	16	20	25
* operating pressure [bar]	275	240	200	175	150	135	100	80
min. bending radius [mm]	50	75	100	120	135	160	200	250

* temperature correction value: 100 °C × 0.9 200 °C × 0.8 250 °C × 0.6

T2

Smooth PTFE hose with two braided layers of stainless steel wire (1.4301), max. operating temperature 250 °C

nominal diameter	6	8	10	12	16	20	25	32	40
* operating pressure [bar]	275	250	225	200	175	150	130	70	50
min. bending radius [mm]	75	100	120	135	160	200	250	500	850

* temperature correction value: 100 °C × 0.9 200 °C × 0.8 250 °C × 0.6

T3

Smooth PTFE hose with two winded and one braided layer of steel wire (1.4301), max. operating temperature 250 °C

nominal diameter	6	8	10	12	16	20	25
* operating pressure [bar]	500	475	475	450	400	300	275
min. bending radius [mm]	60	85	110	150	175	200	240

* temperature correction value: 100 °C × 0.9 200 °C × 0.8 250 °C × 0.6

T5

Corrugated stainless steel hose (1.4401 or 1.4571) with one braided layer of stainless steel wire (1.4301), max. operating temperature 550 °C

nominal diameter	4	6	8	10	12	16	20	25	32	40	50
* operating pressure [bar]	100	150	100	80	64	64	50	40	30	25	20
min. bending radius [mm]	80	80	100	150	170	190	220	250	290	480	550

* temperature correction value: 100 °C × 0.7 200 °C × 0.6 250 °C × 0.55 350 °C × 0.49 500 °C × 0.46

nominal diameter DN	inner diameter armature
4	3.0 mm
6	4.5 mm
8	6.0 mm
10	7.5 mm
12	10.0 mm
16	12.5 mm
20	16.0 mm
25	20.1 mm
32	27.5 mm
40	31.5 mm

Armatures

Our standard heating hoses have armatures made of bichromate machining steel. We also offer armatures made of stainless steel (1.4301 / 1.4571) or brass. The durability of the heating hose and armature should correspond. On request, the heating hoses can be equipped with loose flanges or integral flanges, according to DIN and ASA.

Please consider that armatures narrow the passage of the hose! See table on left.

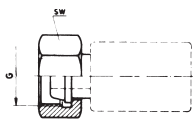

DKR DIN 3863
Universal conical nipple, union nut inch (BSP)

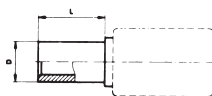

RSL/RSS
pipe connection, light/heavy duty series for clamp ring connection

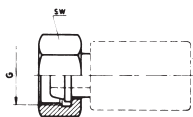

DKL/DKM/DKS DIN 3863
Universal conical nipple, union nut metric thread, light/heavy duty series

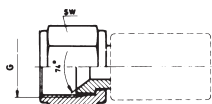

DKJ
Nipple with 74° conus JIC, union nut UNF thread

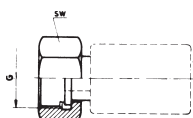

BDN
Flanged nut, flat packing, union nut metric/inch

nominal diameter DN	inch thread	inch thread
4	G 1/8" - 28	G 1/4" - 19
6	G 1/4" - 19	
8	G 3/8" - 19	
10	G 3/8" - 19	G 1/2" - 14
12	G 1/2" - 14	G 5/8" - 14

nominal diam. DN	outer diameter of tube light	outer diameter of tube heavy
4	6	8
6	8	10
8	10	12
10	12	14
12	15	16

nominal diameter DN	DKL	DKM	DKS
4	12 × 1.5		
6	14 × 1.5		18 × 1.5
8	16 × 1.5		20 × 1.5
10	18 × 1.5		22 × 1.5
12	22 × 1.5		24 × 1.5

nominal diameter DN	inch thread	inch thread
4	7/16"	20 UNF
6	1/2"	20 UNF
8	1/2"	20 UNF
8	9/16"	18 UNF
8	5/8"	18 UNF
10	9/16"	18 UNF
10	3/4"	16 UNF

nominal diam. DN	inch thread	metric thread
4	R 1/4"	14 × 1.5
8	R 3/8"	16 × 1.5
10	R 3/8"	18 × 1.5
10	R 1/2"	
12	R 1/2"	22 × 1.5

nominal diameter DN	inch thread	inch thread	inch thread
16	G 3/4" - 14		
20	G 1" - 11		
25	G 1" - 11	G 1 1/4" - 11	
32	G 1 1/4" - 11	G 1 1/2" - 11	
40	G 1 1/2" - 11		

nominal diam. DN	outer diameter of tube light	outer diameter of tube heavy
16	18	20
20	22	25
25	28	30
32	35	38
40	42	

nominal diameter DN	DKL	DKM	DKS
16	26 × 1.5		30 × 2
20	30 × 2	30 × 1.5	36 × 2
25	36 × 2	38 × 1.5	42 × 2
32	45 × 2	45 × 1.5	52 × 2
40	52 × 2	52 × 1.5	

nominal diameter DN	inch thread	inch thread
12	3/4"	16 UNF
16	7/8"	14 UNF
20	1 1/16"	12 UNF
25	1 5/16"	12 UNF
32	1 5/8"	12 UNF
40	1 7/8"	12 UNF

nominal diam. DN	inch thread	metric thread
16	R 3/4"	26 × 1.5
20	R 1"	30 × 2
25	R 1 1/4"	36 × 2
32	R 1 3/4"	52 × 2
40	R 1 1/2"	

order no.	option: armatures V2A on both sides
89 20 25	nominal diameter DN 04 - 10
89 20 26	nominal diameter DN 12 - 16
89 20 27	nominal diameter DN 20

order no.	option: armatures V4A on both sides
89 20 28	nominal diameter DN 04 - 10
89 20 29	nominal diameter DN 12 - 16
89 20 30	nominal diameter DN 20